

**THE PLACE THEATRE**  
*Essex Road's Premier Performance Venue*  
**SEATING and GENERAL LAYOUT DIAGRAM**  
**ISSUE 1**

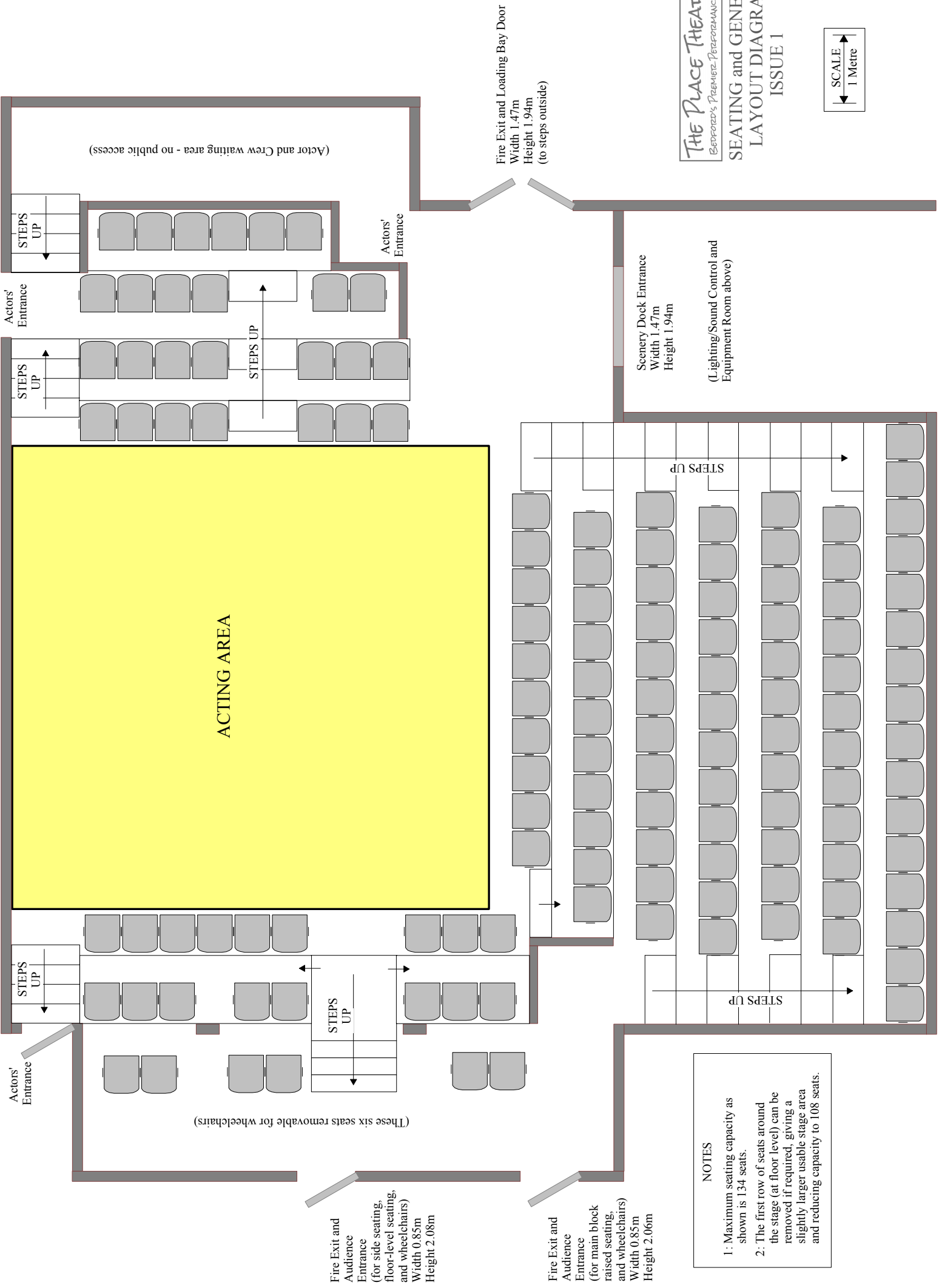

ACTING AREA

Actors' Entrance

STEPS UP

STEPS UP

Actors' Entrance

STEPS UP

Actors' Entrance

STEPS UP

STEPS UP

STEPS UP

Scenery Dock Entrance  
Width 1.47m  
Height 1.94m

(Lighting/Sound Control and Equipment Room above)

STEPS UP

STEPS UP

Fire Exit and Loading Bay Door  
Width 1.47m  
Height 1.94m  
(to steps outside)

Fire Exit and Audience Entrance  
(for side seating, floor-level seating, and wheelchairs)  
Width 0.85m  
Height 2.08m

Fire Exit and Audience Entrance  
(for main block raised seating, and wheelchairs)  
Width 0.85m  
Height 2.06m

(These six seats removable for wheelchairs)

**NOTES**

- 1: Maximum seating capacity as shown is 134 seats.
- 2: The first row of seats around the stage (at floor level) can be removed if required, giving a slightly larger usable stage area and reducing capacity to 108 seats.